

# *MANUAL***ARMADO**

## ROAL UFFICI-1000T

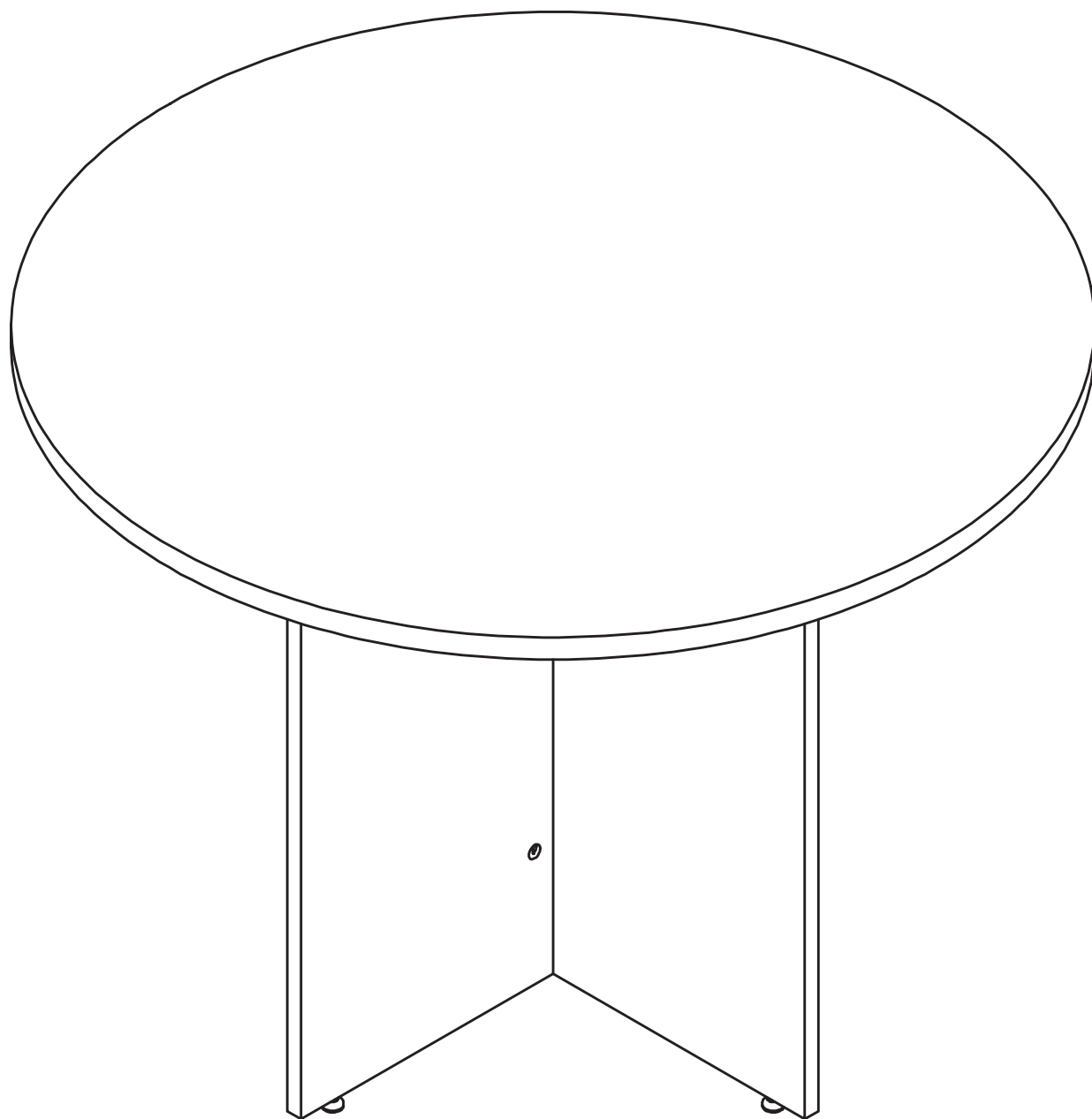

Herramientas necesarias:

**Atornillador de Cruz  
(no incluido)**

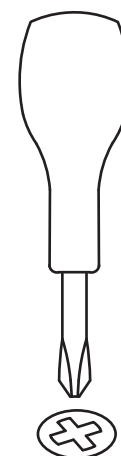

### **¡Precaución!**

Para evitar volcamiento del mueble no debe sobrecargarse.

Este mueble debe ser armado por un adulto. En caso de duda, busca asesoramiento profesional. Lee y sigue cada paso de las instrucciones cuidadosamente.

# PARTES Y PIEZAS

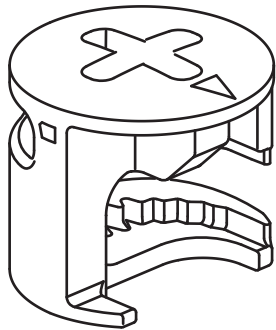

x8

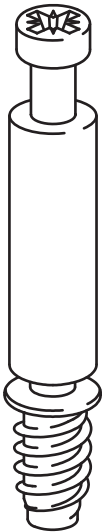

x8

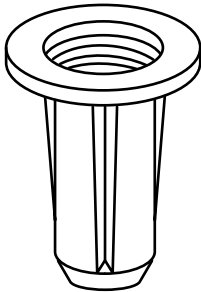

x4

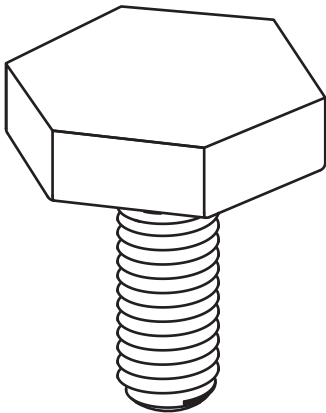

x4

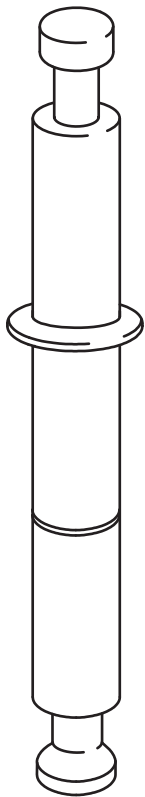

x2

# PARTES Y PIEZAS

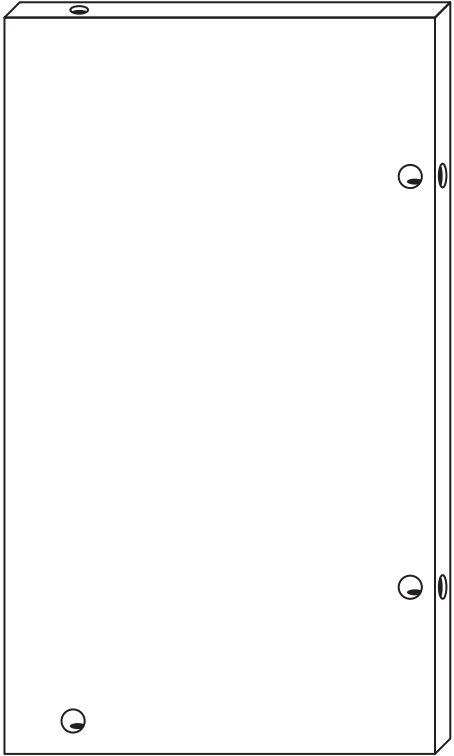
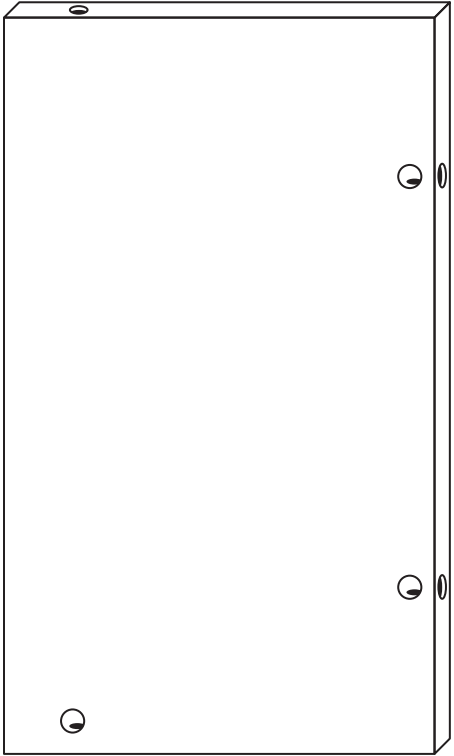
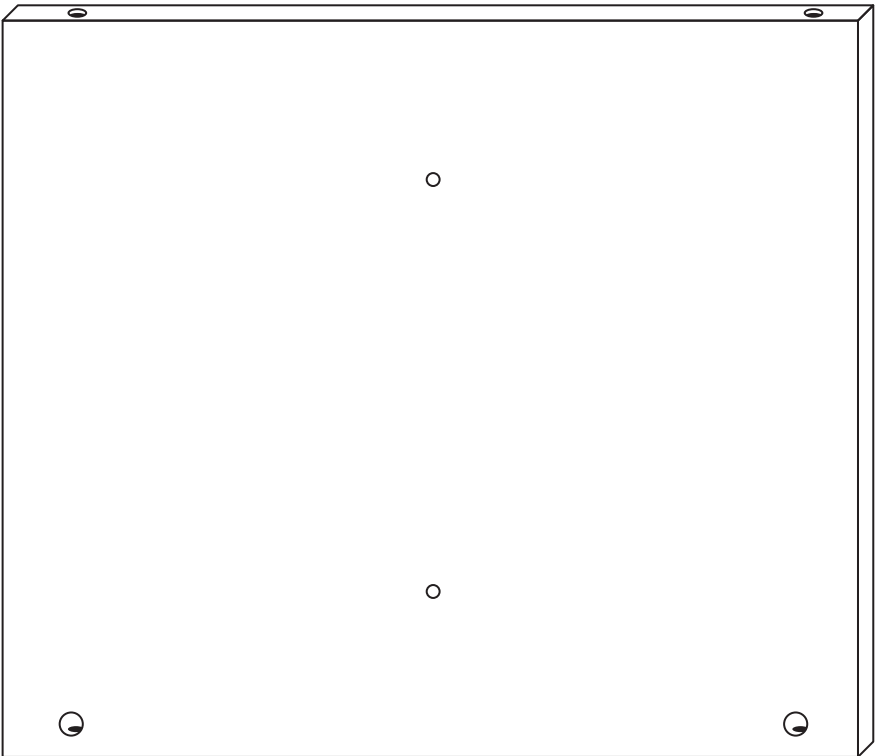
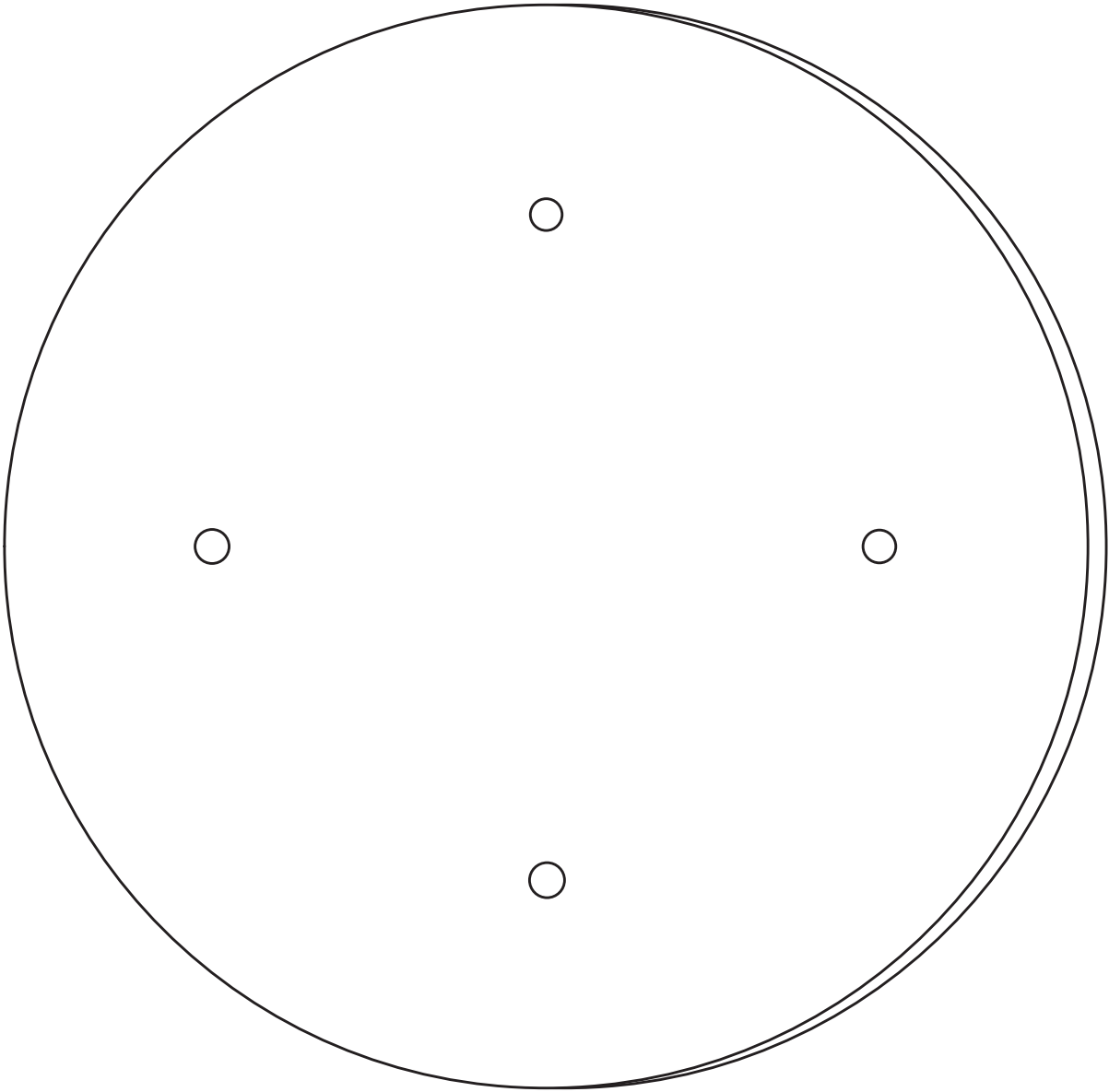

# MONTAJE

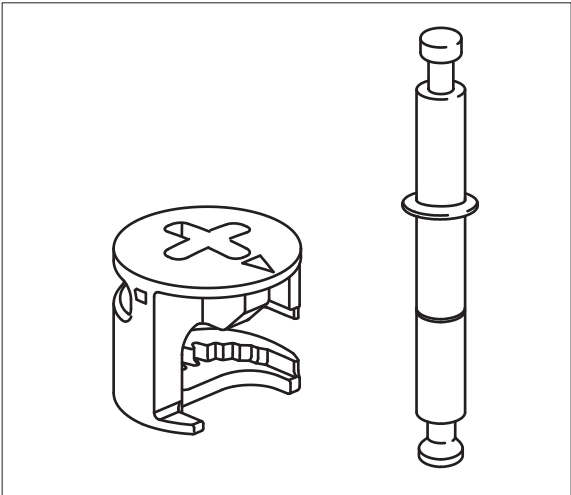
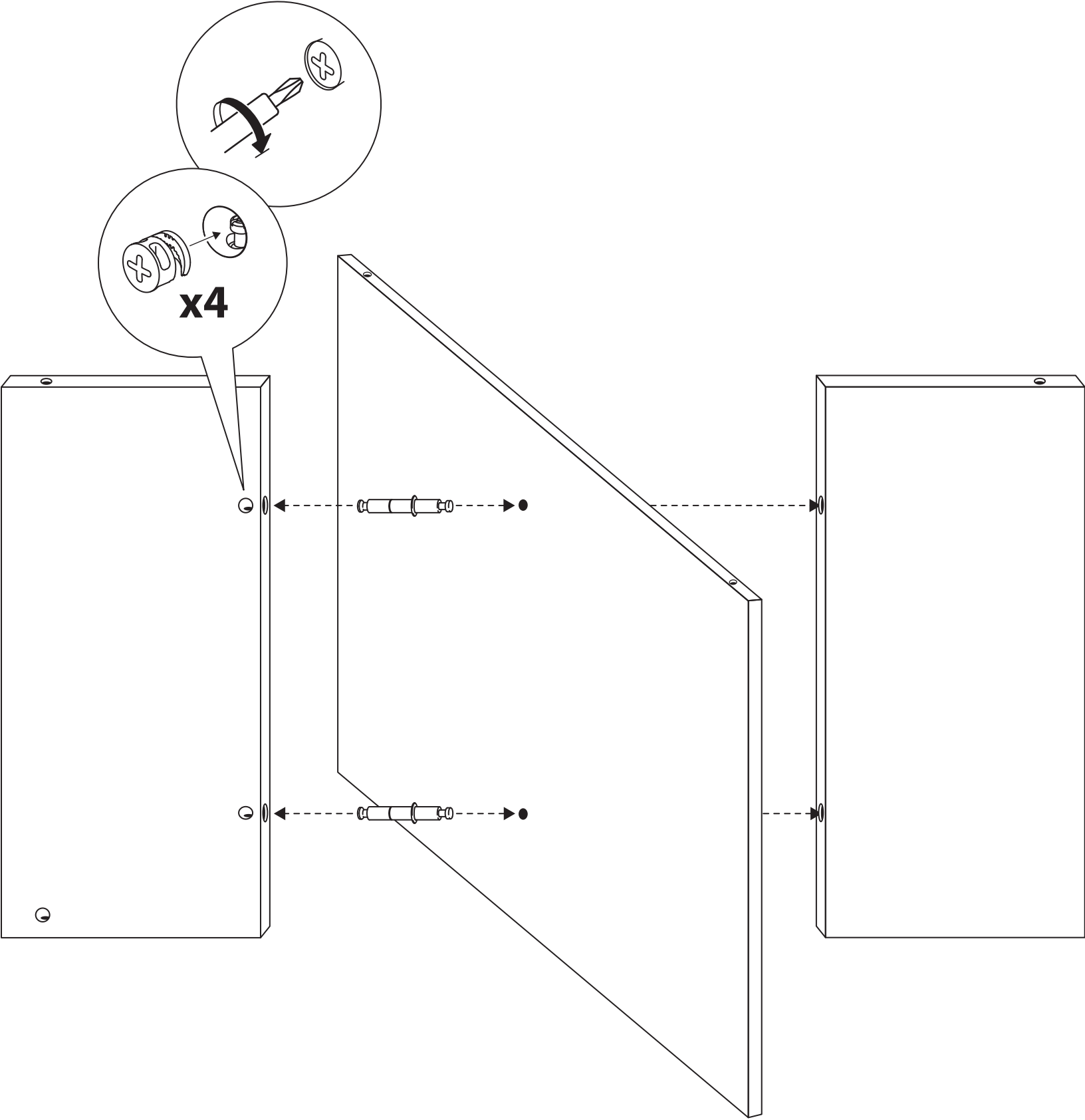

# MONTAJE

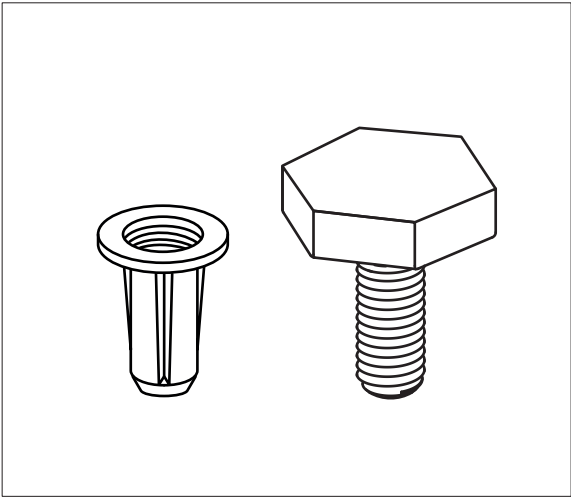
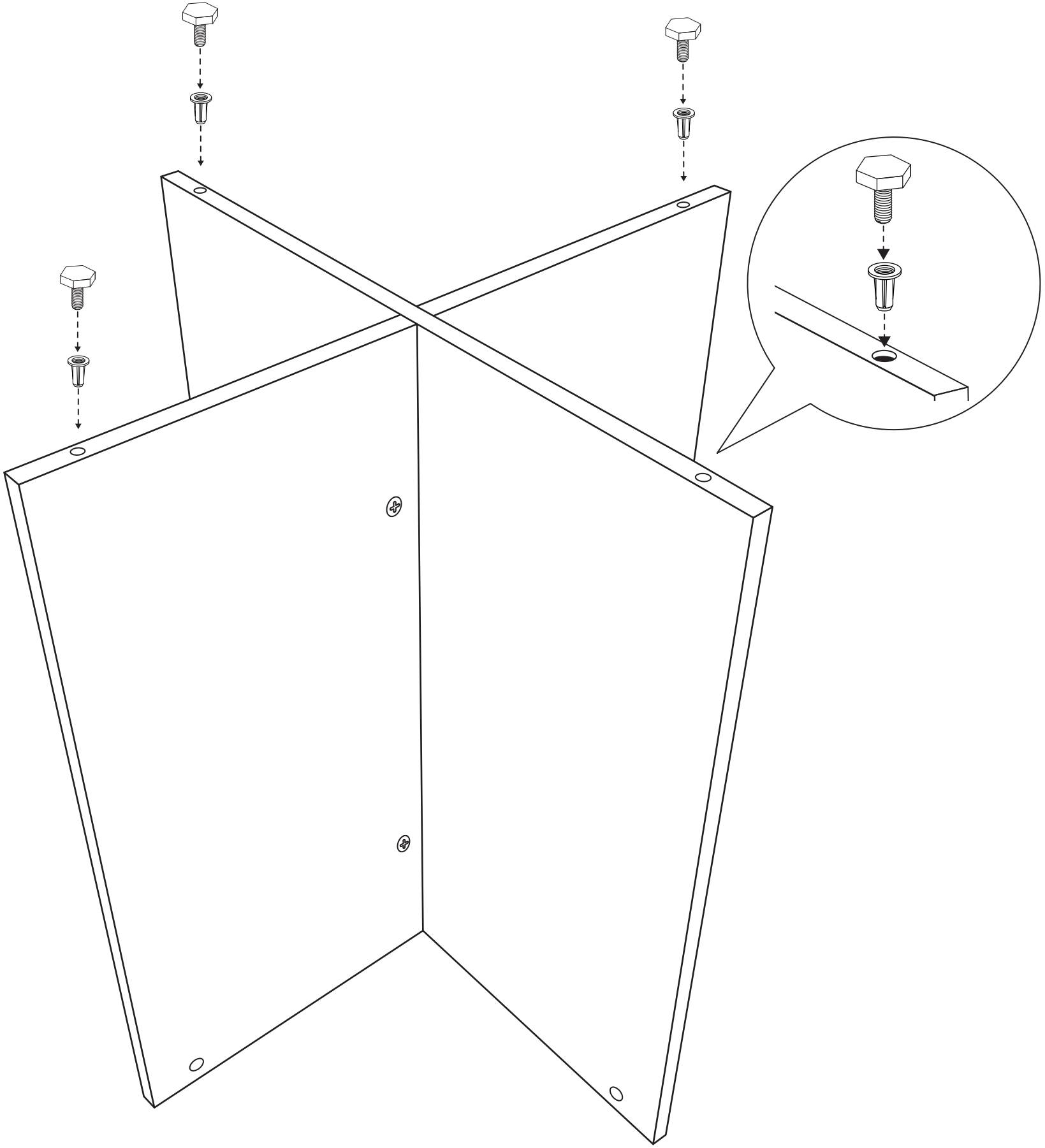

# MONTAJE

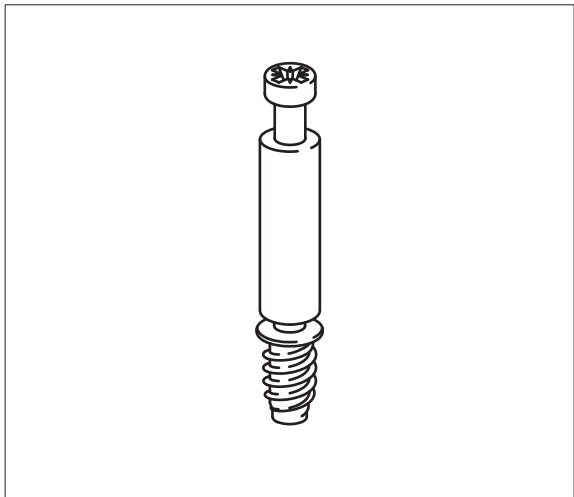
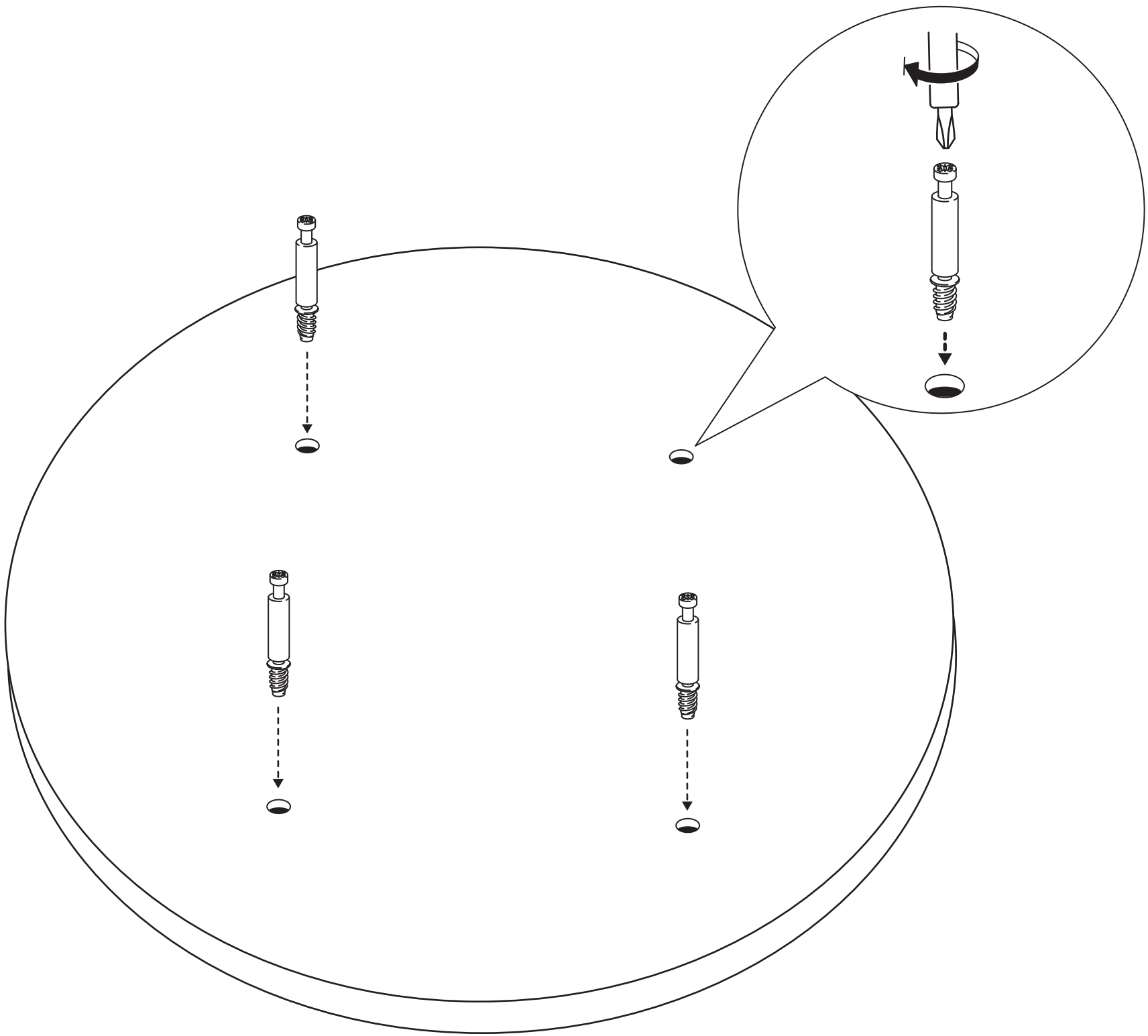

ROAL UFFICI-1000T

# MONTAJE

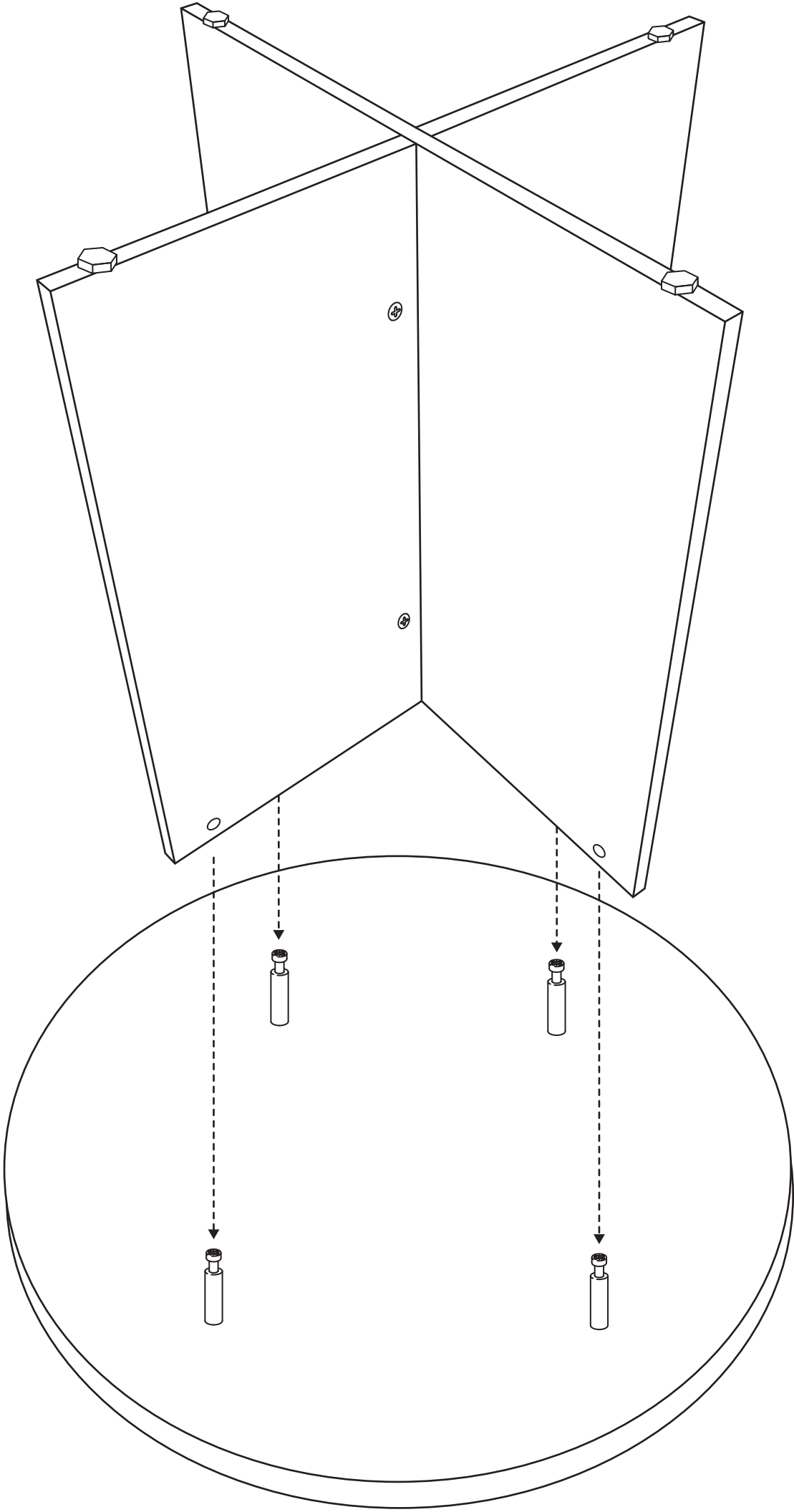



# MONTAJE

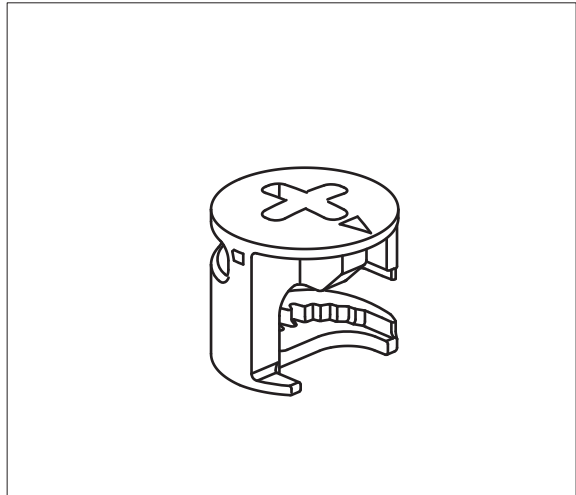
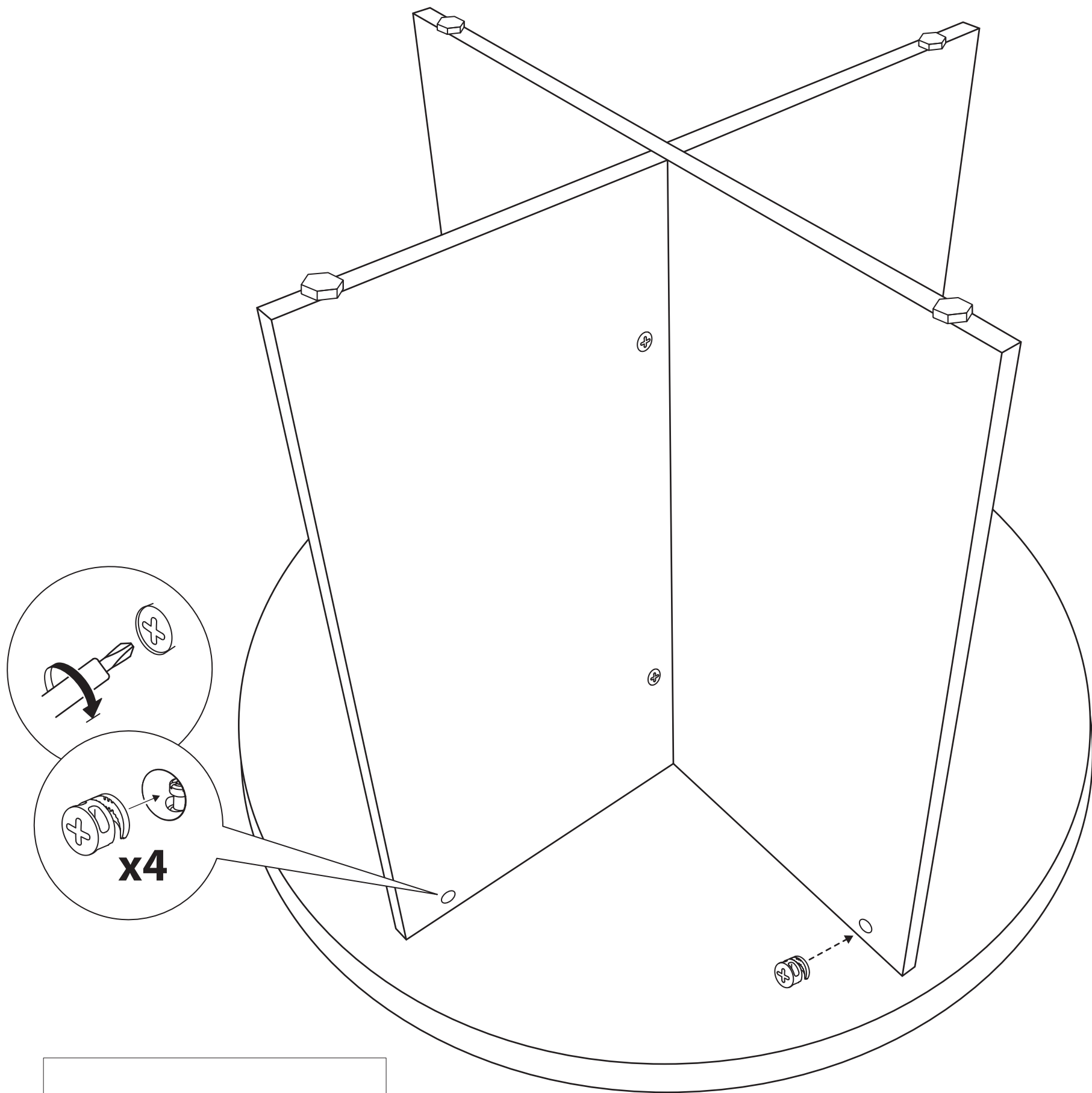

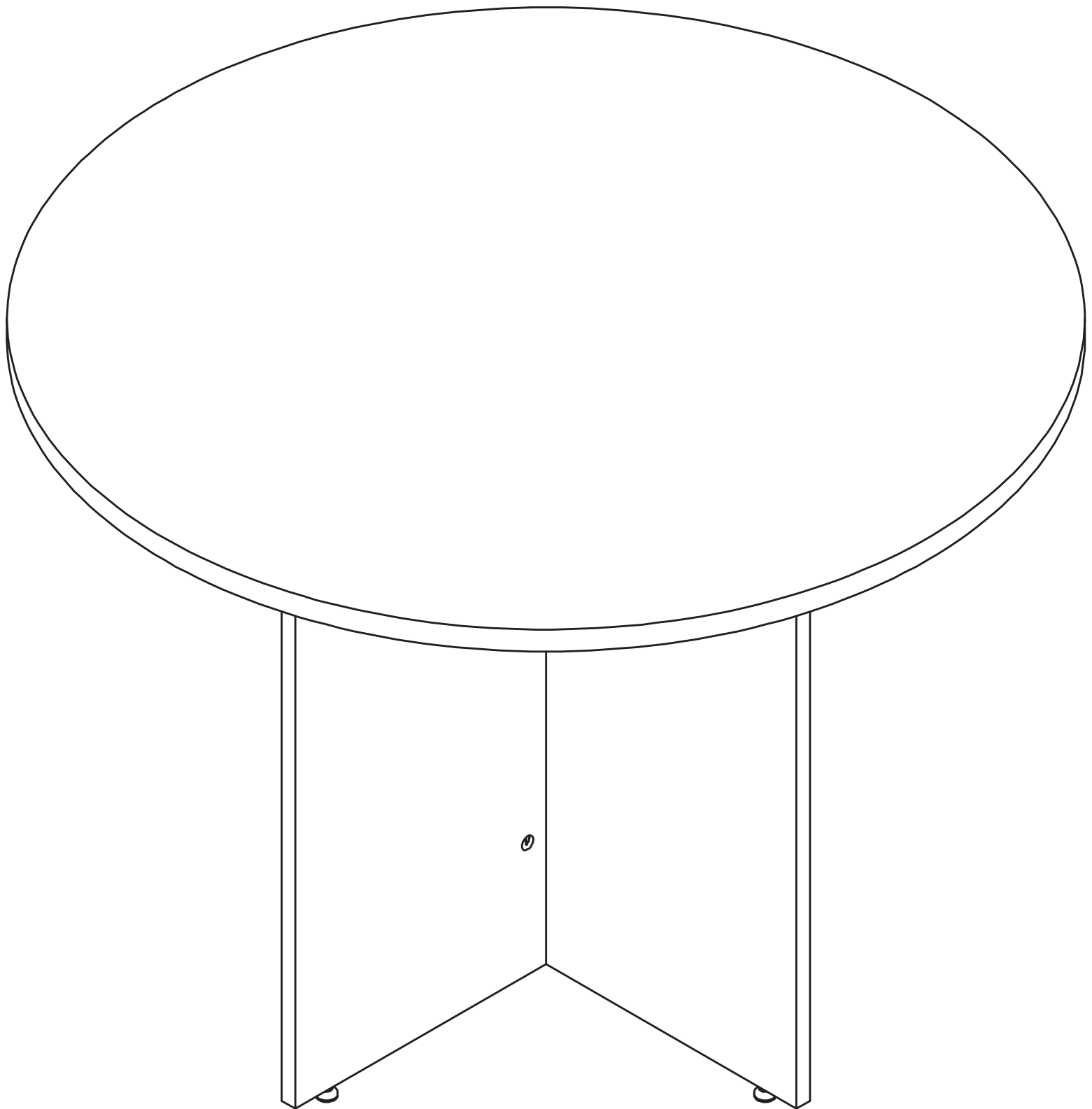

**ROAL UFFICI-1000T**